

88 Venice Court, Andover, SP10 5JQ
Asking Price £185,000

PROPERTY DESCRIPTION BY *Mr Guy Sommerville*

Nestled in the sought-after Roman Way development on the northern side of Andover, this mid-1960s terraced house offers versatile living spaces perfect for families. Originally built to accommodate families moving out of London, the property features a spacious layout over two floors. The ground floor comprises a well-proportioned kitchen/dining room at the front, a sitting room at the rear, and a flexible third bedroom or second reception room. Upstairs, you'll find two comfortable bedrooms, a family bathroom, and a separate toilet. The property boasts an enclosed rear garden, ideal for outdoor activities and relaxation. Unusually, the sale includes a garage located underneath the house, providing ample storage and parking solutions. While the house would benefit from a program of restoration, it presents an excellent "move in and do" opportunity for buyers looking to customise and update their new home. Don't miss the chance to make this versatile property your own.

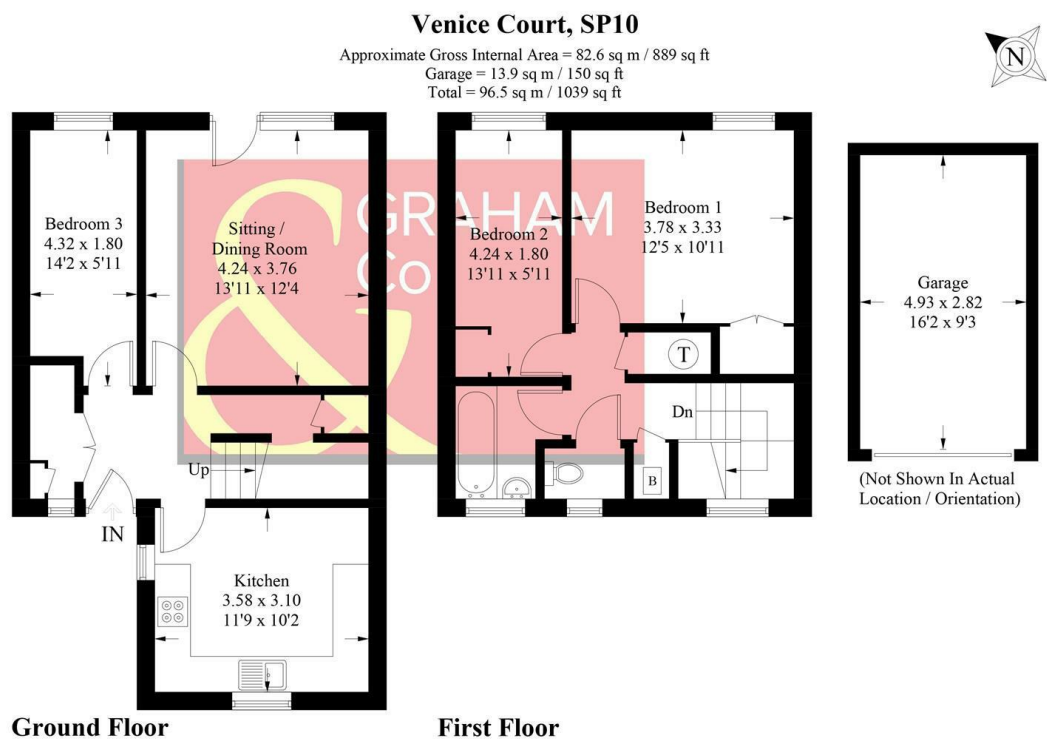

PRODUCED FOR GRAHAM AND CO
Whilst every attempt has been made to ensure the accuracy of the floorplan, measurements of doors, windows and rooms are approximate. These plans are for representation purposes only as defined by RICS Code of Measuring Practice and used as such by any prospective purchaser. © Emzo Marketing (ID1083451)

DIRECTIONS

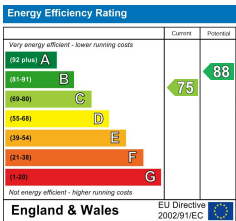

Tax Band: B



OPEN 7 DAYS

If you are considering selling your home please contact us today for your free no obligation valuation

01264 356500

IMPORTANT: we would like to inform prospective purchasers that these sales particulars have been prepared as a general guide only. A detailed survey has not been carried out, nor the services, appliances and fittings tested. Room sizes should not be relied upon for furnishing purposes and are approximate. If floor plans are included, they are for guidance only and illustration purposes only and may not be to scale. If there are any important matters likely to affect your decision to buy, please contact us before viewing the property.